

## LAYER STRUCTURE

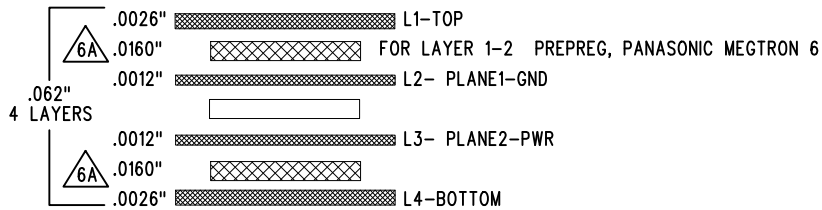

SIZE	QTY	SYM	PLATED	TOL
0.006	1024	+	YES	+/-0.003
0.066	4	X	YES	+/-0.003

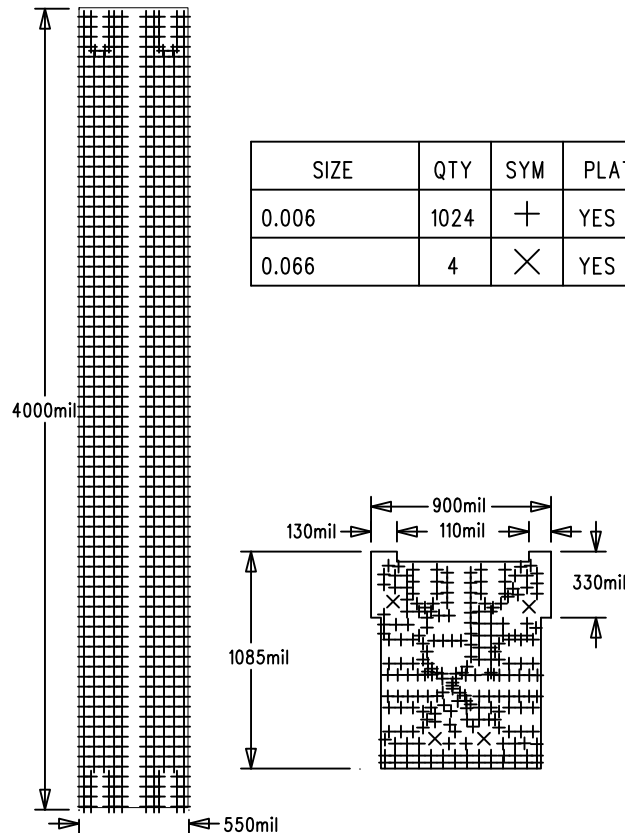

LTC DESIGNED  
IMPEDANCE TEST  
STRUCTURE COUPON

DRILL DRAWING LAYER  
LINEAR TECHNOLOGY DATE: 11-23-15  
DC2461A-2 \* LTC5548  
2-14 GHz PASSIVE MIXER

## REVISION HISTORY

ECO	REV	DESCRIPTION	APP. ENG.	DATE
-	2	PRODUCTION	WESTON S.	11-23-15

## NOTES: UNLESS OTHERWISE SPECIFIED

- FAB PER IPC-A-600.
- MATERIAL: FOR LAYER 1-2 PREPREG, PANASONIC MEGTRON 6  
FOR LAYER 2-3-4 - ISOLA FR-370HR OR EQUIVALENT  
-FINISHED THICKNESS TO BE 0.062" +/- .005"  
-TOTAL OF 4 LAYERS WITH 2 OZ. CU ON THE OUTER LAYERS AND 1 OZ. CU ON THE INNER LAYERS.  
-FLAMMABILITY RATING: 94 V-0 MINIMUM.
- SIZE: CUT TO DIMENSIONS AND TOLERANCES SHOWN.  
0.00" ARE PRIMARY DATUMS.
- DRILLING: -DRILL HOLES PER SCHEDULE. PLATE THROUGH HOLES WITH COPPER, 0.001" THICK MIN.  
-ALL HOLE SIZES ARE SPECIFIED AFTER PLATING.  
-HOLE LOCATION TOLERANCES ARE +/-0.003" IN RELATION TO CENTER
- FINISH: -SMOBC USING LPI BOTH SIDES, COLOR GREEN.  
-GOLD IMMERSION BOTH SIDES.  
-FOR SILKSCREENS: USE WHITE NON-CONDUCTIVE INK.
- CONTROLLED 50 OHM +/-5% IMPEDANCE FOR LAYER 1-2 TRACE WIDTH 27 MILS.
- SUBJECT TO CHANGE BY MANUFACTURER, DEPENDING ON DIELECTRIC CONSTANT DEVIATIONS. PLEASE CONSULT LTC.
- DO NOT ALTER ARTWORK e.g. TO ADD LOGO OR DATE CODE.  
PAD SIZE CAN BE MODIFIED TO MEET END FINISH.
- PCBS ARE TO BE RoHS COMPLIANT.
- PERFORM SCORING PER ITEM "A".
- LTC DESIGNED IMPEDANCE TEST COUPON REQUIRED!

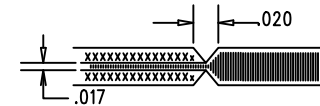

## UNLESS OTHERWISE SPECIFIED

DIMENSIONS ARE IN INCHES  
TOLERANCES:  
0.XX" = ±0.01"  
0.XXX" = ±0.005"  
INTERPRET DIM AND TOL  
PER ASME Y14.5M-1994  
THIRD ANGLE PROJECTION

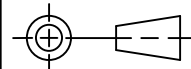

## APPROVALS

PCB DES.	SM
APP ENG.	WESTON S.
SCALE = NONE	

## TECHNOLOGY

TITLE: FABRICATION DRAWING

2-14 GHz PASSIVE MIXER

SIZE	IC NO.	LTC5548	REV
N/A	DEMO CIRCUIT	2461A	2
FILENAME: LT5548.PCB	SHT 1 OF 1		

1630 MCCARTHY BLVD  
MILPITAS, CA 95035  
PH: (408)432-1900  
www.linear.com  
LTC CONFIDENTIAL-  
FOR CUSTOMER USE ONLY